

IQ Plus Operation Guide - Extraction Procedure

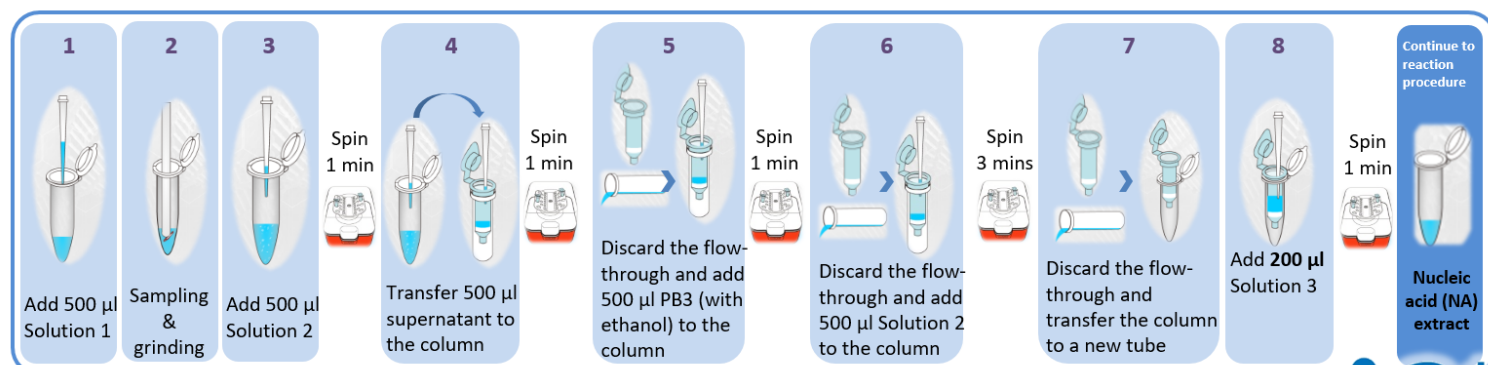

*Please refer to IQ Plus Extraction Kit User Manual for the details.

GeneReach Biotechnology Corp.



IQ Plus Operation Guide - Reaction Procedure

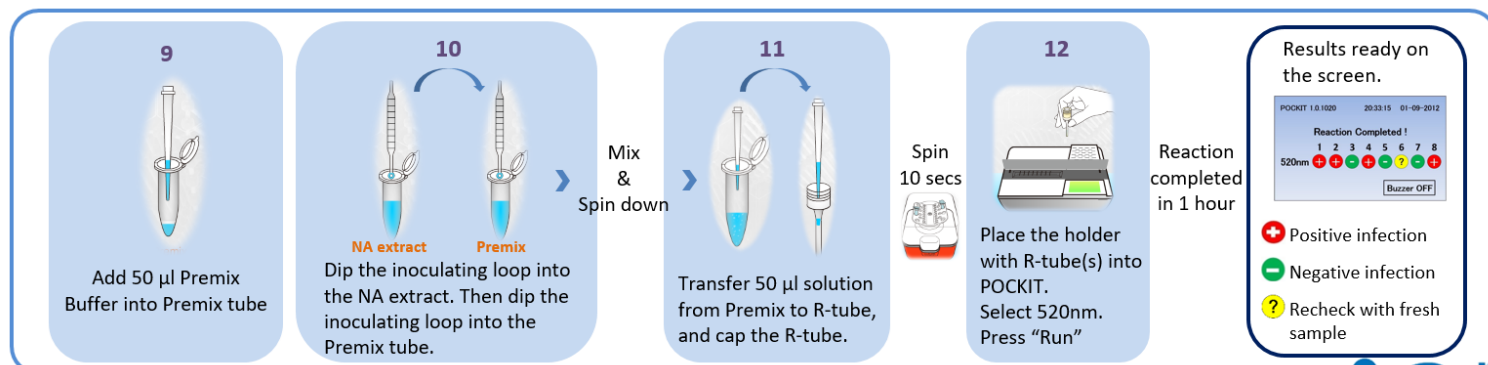

*Please refer to IQ Plus User Manual for the details.

GeneReach Biotechnology Corp.



Sampling Instruction	
Sample Type	Amount
Spleen	< 50 mg
Kidney	< 50 mg
Brain	< 50 mg
Eyes	< 50 mg Note: For fingerlings (< 2.5 cm), please collect five eyes as sample for nucleic acid extraction.

* Please refer to IQ plus reagent set user manual for details.

2019/05

GeneReach Biotechnology Corp.

