

## IQ Plus Operation Guide - Extraction Procedure

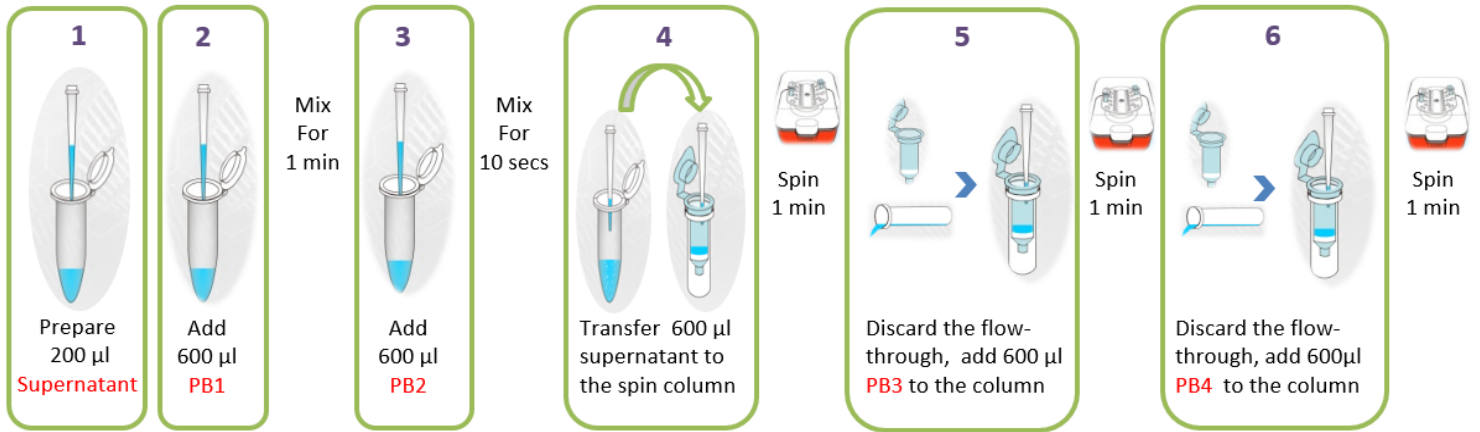

\*Please refer to PetNAD Nucleic Acid Co-prep Kit User Manual for details.

GeneReach Biotechnology Corp.  
www.genereach.com

## IQ Plus Operation Guide – Extraction & Reaction Procedure

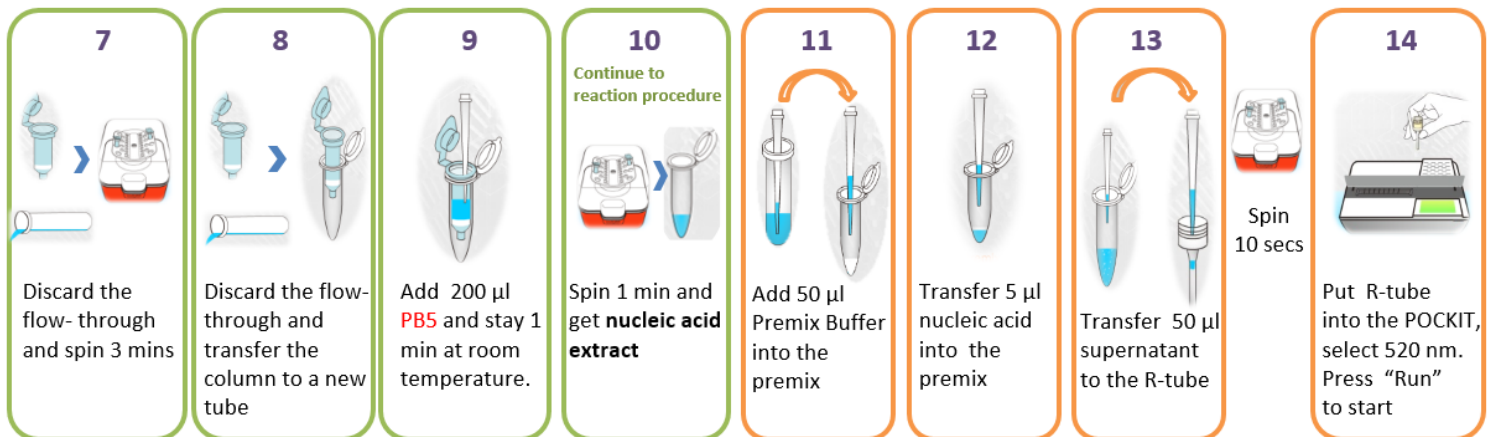

\*Please refer to PetNAD Nucleic Acid Co-prep Kit User Manual for details.

GeneReach Biotechnology Corp.  
www.genereach.com

Results ready on the screen.

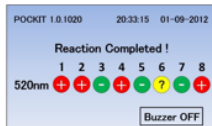

- + Positive infection
- Negative infection
- ? Recheck with fresh sample

### Sampling Instruction

Sample types	Pretreatment	Input
Tissue	Place 40 mg tissue samples into a clean 1.5 ml microcentrifuge tube with 0.5 ml phosphate buffered saline (PBS). Use a grinder to homogenize tissue samples. Spin the tube for 1 minute.	200 µl Supernatant

\* Please refer to IQ plus reagent set user manual for details.

GeneReach Biotechnology Corp.  
www.genereach.com

iQ<sup>+</sup>